



### PROPERTIES

Stroke Length:	25.4mm (1")
Net Pull Force:	62.3 Newtons (14lbf)
Net Hold Force:	120 Newtons (27lbf)
Weight:	0.77 kg (1.7lbs)

### MECHANICAL

Termination:	6-32 UNC studs
Shaft thread:	1/4-28 UNF male
Shaft length:	25.4mm (1")

### ELECTRICAL

Pull Current:	42 Amps @ 12VDC
Hold Current:	0.8 Amps @ 12VDC
Design Voltage:	12VDC (24VDC optional)
Duty Cycle:	100% of rated voltage @25°C
Insulation:	Ungrounded

### AVAILABLE OPTIONS

Return springs:	Light and heavy duty
Mounting brackets:	Flange mounting model

The D610 range of solenoid actuators offer a proven and reliable electromechanical solution for pull and hold functions. An integral changeover contact switches the pull coil to the hold coil thus eliminating the need for additional relays or controllers. The dual wound coil design provides high energy pulling performance while maintaining a low powered continuous holding operation. Ideal for damper/flap control, engine shutdown/throttling and general actuation requirements.

\* detailed information available upon request

## Models

Model	Voltage	Configuration	Light Spring P/N	Heavy Spring P/N	Mounting
D610-A1V12	12VDC	Internally switched	F09514	F09513	Side

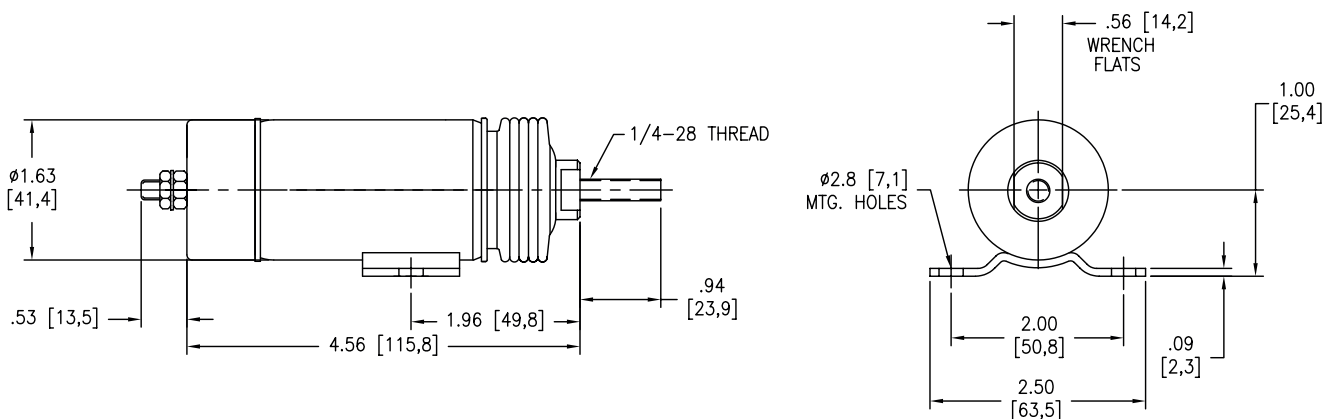

Proudly distributed by:



16 Parkinson Lane  
O'Connor WA 6163  
Australia

**Phone** +61 8 9331 3100  
**Fax** +61 8 9331 5150  
**Email** [mail@amelec.com.au](mailto:mail@amelec.com.au)  
**Web** [www.amelec.com.au](http://www.amelec.com.au)