



ELECTRICAL

Contact Rating:	75 Amps for 5 minutes* 150 Amps peak inrush (copper)* 500 Amps peak inrush (silver)*
Contact State:	Normally Open (N/O)
Contact Life:	Copper – 10K cycles Silver Alloy – 5K cycles
Coil Voltage:	12VDC or 24VDC*
Coil Duty Cycle:	20% @25°C*
Insulation:	Ungrounded

MECHANICAL

Coil terminals:	1/4" (6.35mm) QC Terminals
Contact Terminals:	5/16-24 Studs

ENVIRONMENTAL

Operating Temp:	-40°C to +60°C
Sealing:	Unsealed

AVAILABLE OPTIONS

- Hose clamp mounting bracket;
- Silver plated contact studs.

Trombetta's Reversing Polarity (RP) DC contactors provide a cost effective and simple solution for reversing direction of permanent magnet DC motors. By integrating two DC Contactors into a single unit, Trombetta has provided an efficient means for manufacturers and installers to reduce assembly costs. The RP is perfect for any application that requires reversing motion, such as winching, lifting, sliding and levelling systems in a multitude of transport applications.

* detailed information available upon request

Models

Part No.	Voltage	Rating	Coil Duty	Grounding	Contacts	Bracket
214-1231-A11	12VDC	75 Amps	Intermittent	Ungrounded	Copper	Moulded Base
214-1231-A61-06	12VDC	75 Amps	Intermittent	Ungrounded	Silver Alloy	Moulded Base
214-2431-A61-06	24VDC	75 Amps	Intermittent	Ungrounded	Silver Alloy	Moulded Base

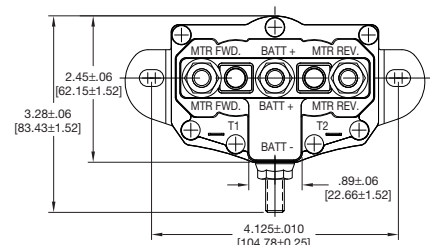
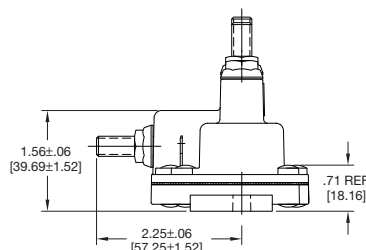
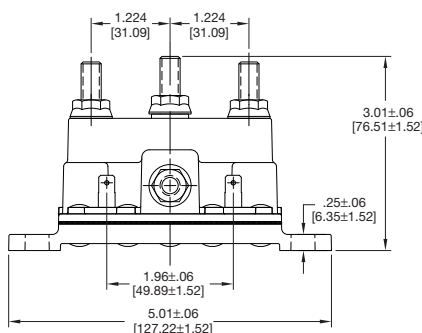

Dimensions in Brackets [] are metric

Proudly distributed by:



16 Parkinson Lane
O'Connor WA 6163
Australia

Phone +61 8 9331 3100
Fax +61 8 9331 5150
Email mail@amelec.com.au
Web www.amelec.com.au